

## LTS HIGH PRESSURE PRODUCTS

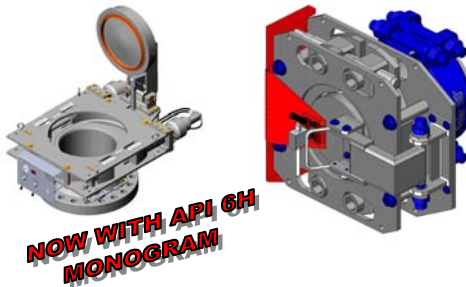

**WIRELOC® CLAMP CONNECTORS:**  
(GRAYLOC®/TECHLOK® EQUIVALENT) VARIOUS MATERIALS  
IN 1" TO 36" SIZES AND THROUGH API 6A 20,000PSI (1,380BAR)

**FLANGETEC® COMPACT FLANGES:**  
(NORSOK L005 & ASME/6A) IN VARIOUS MATERIALS  
IN 1" TO 60" SIZES THROUGH 15,000PSI (1,034BAR)



**CLAMPTEC® PIG LAUNCHER, FILTER & VESSEL CLOSURES:**  
MANUAL AND AUTOMATED DESIGNS, API 6A AND ASME SECTION VIII DIV. 1 / DIV. 2 COMPLIANT, OFFERED IN VARIOUS MATERIALS FROM 6" TO 60" SIZES AND THROUGH 15,000PSI (1,034BAR)

**PRODUCTION & HEATERS CHOKE VALVES:**  
WH2, THORNHILL CRAVER, OCT, JWA, VETCO GRAY AND FMC, CHOKE BEANS, SEATS AND STEMS AS WELL AS CUSTOM APPLICATION IN 2" TO 8" SIZES THROUGH 15,000PSI (1,034BAR)

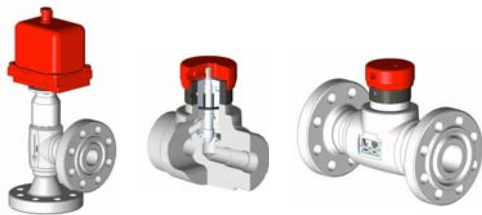
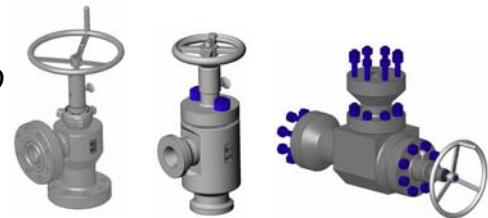

**FLOW CONTROL VALVES:**  
WFCV (MERLA® TYPE) IN-LINE AND RIGHT ANGLED, ACTUATED IN 1" TO 4" SIZES THROUGH 10,000PSI (690BAR)

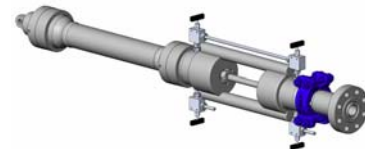

**API WELLHEAD SERVICE EQUIPMENT:**  
BACK PRESSURE VALVE AND VR LUBRICATORS  
IN 2" & 2.1/2" SIZES THROUGH 15,000PSI (1,034BAR)

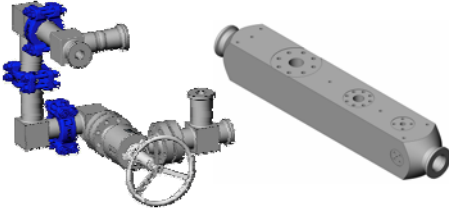

**API WELLHEAD EQUIPMENT:**

API RING GASKETS, TREE TOP CONNECTIONS, API FLANGES, SPOOLS, ADAPTERS, INSTRUMENTATION RINGS AND FLANGES, BLAST SPOOLS, FLOWLINES THROUGH 20,000PSI (1,380BAR)

**HEAT EXCHANGER (GAS LIFT):**

WHFCV FLUID ACTIVATED HEAT EXCHANGER USING WFCV VALVE, REGULATED FLOW CONTROL THROUGH 5,000PSI (345BAR)

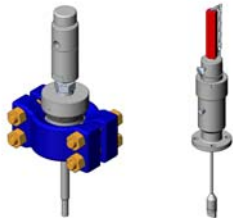

**SAND AND CORROSION MONITORING:**

IN-LINE SAND PROBE AND COUPON HOLDERS THROUGH 20,000PSI (1,380BAR), RETRACTABLE SINGLE AND DUAL COUPON HOLDER SYSTEMS THROUGH 5,000PSI (345BAR)

**PACKAGED EQUIPMENT:**

HIGH PRESSURE PIG LAUNCHER / RECEIVER SKIDS, PRODUCTION MANIFOLDS, FLOWLINES AND METERING SKIDS THROUGH 15,000PSI (1.034BAR)

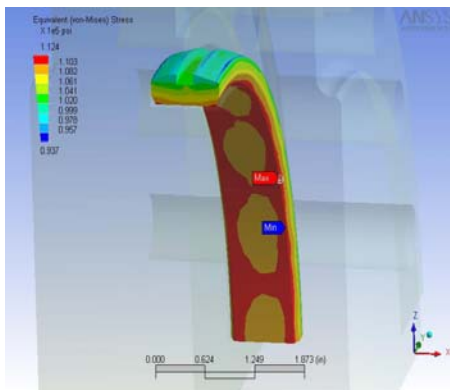
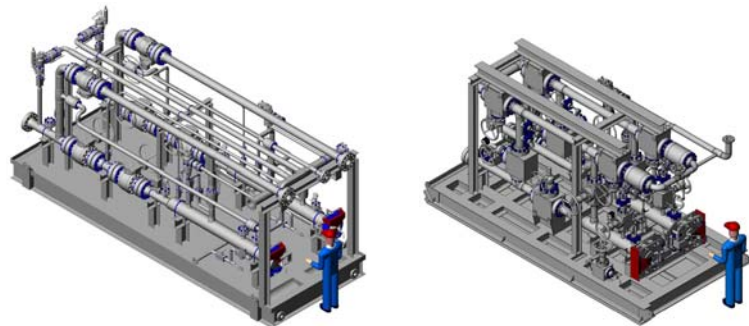

**Design & Engineering Support** - LTS provides analytical calculation methods in accordance with ASME **Section VIII Division 1, 2 and 3 methods**, as well as **COSMOS Linear & Non Linear FEA** supporting dynamic load, combination loads, and thermal load applications.

**Design Verification** - Building on our extensive **High Pressure and High Temperature** experience, LTS offers Project specific **Prototype testing**, as well as **Third Party** design review through DNV, Lloyds, CDS, ABS and Bureau Veritas as required.